

Layout

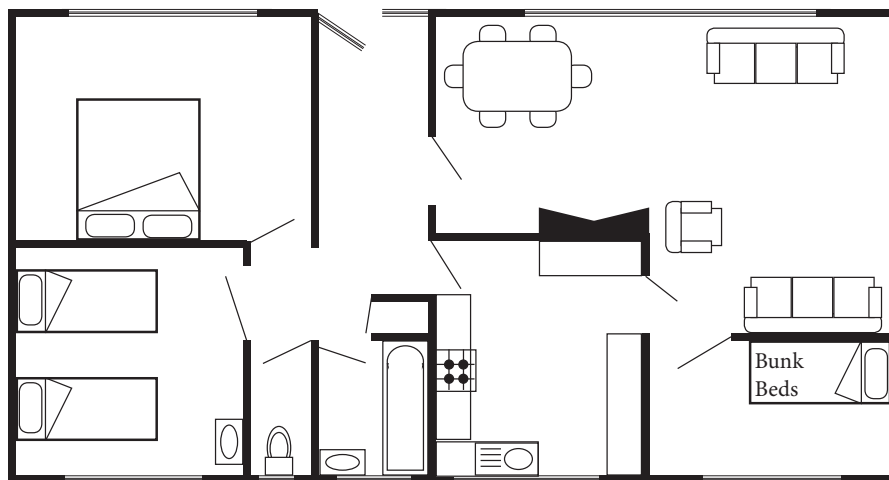

- Sleeps 6
- Double, twin and bunk arrangements
- Close to town centre
- Laundry facilities
- Dishwasher
- Pets welcome
- Children welcome
- Convenient for beaches

Directions from the Quay Walking time: 8 - 10 minutes

Head towards the entrance to the quay
Turn left at The Mermaid Inn on to Hugh Street
Continue along Hugh Street to Bordeaux shop
Cross the road to the Town Hall

Walk straight ahead on to Church Street
Turn right at Foredeck Saleroom
Take first left into Rams Valley
Merrick is about 50 yards on the left

