

LIFEBOAT VIEW

Thorofare, St Mary's

Sleeps 2 | Mar - October | Saturday changeover



Lifeboat View is a studio apartment on the ground floor of Smugglers Ride, an impressive granite building located on Town Beach, which was once a guest house and has subsequently been converted into self-catering apartments.

The living area makes maximum use of the space available and comprises a bed-sitting room, with a feature window seat, a dining kitchen with a splendid view of the harbour, and of course the lifeboat at anchor, and a shower room.

Sleeping two in a sofa bed, this flat is also very well suited to the solo traveller.

Situated on The Thorofare, a quiet lane running almost parallel to the main street in Hugh Town, Lifeboat View is within a short walk of most island amenities.

Layout

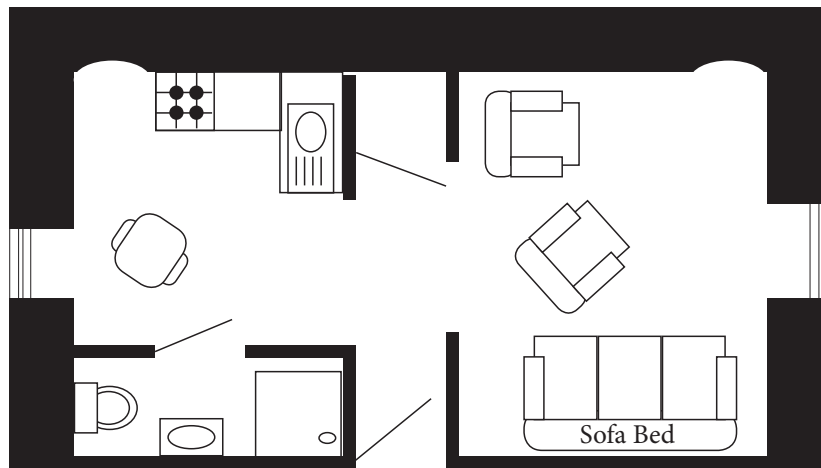

- Sleeps 2
- Ideal for the solo traveller
- Sea views
- Internet access
- Children welcome
- Town centre location

Directions from the Quay Walking time: 5 minutes

Head towards the entrance to the quay
 Turn left at The Mermaid Inn on to Hugh Street
 Keep to the left side of the road
 Go as far as the IOS Steamship Co. office

Turn left into the alley
 At the bottom of the alley turn right
 The entrance to Smugglers Ride is on the left
 Lifeboat View is on the ground floor

